

BACK MOUNT SANDWICH PREP. TABLES



EPBN - Series

Back Mounted
Condensing Unit

MODELS: EPBNR1
EPBNSR2
EPBNR2
EPBNWR2
EPBNR3

Project / Customer _____

Item No. _____

Model No. _____



EPBNR1



EPBNSR2



EPBNR2



EPBNWR2



EPBNR3

Please visit our website for updated [Energy Efficiency](#) information.

Cabinet Construction

Heavy duty 430 stainless steel door and side walls of exterior, and galvanized steel finished bottom and back wall of exterior. High quality 304 stainless steel interior, worktop, top lid and hood. Insulated with 2.5" thick high density foamed-in-place polyurethane foam. Four 4" diameter casters (front casters with brakes). Door heater installed around inside cabinet frame to prevent moisture build up.

Refrigeration System

- Back mounted condensing unit
- Oversized condenser and evaporator coil cools to set temperature in a minimum time period and maintains it
- Slide-out condensing unit for convenient repair and maintenance
- Front air breathing for built-in applications
- Environmentally friendly CFC free R-134A refrigerant
- Air defrost by electrical timer
- Copper tube and aluminum fin evaporator with anti-corrosive coating
- Energy efficient condensate drain pan assembly heated by high side copper tube
- Pressure relief port located at exterior back wall for rapid re-entry
- Pre-wired and ready to plug, 115V/60Hz/1Ph, NEMA 5-15P

Doors

- 430 stainless steel exterior with 304 stainless steel interior
- Insulated with 2.5" thick foamed-in-place polyurethane foam
- Rounded corners for a sleek and modern appearance
- Heavy duty adjustable torsion spring self-closing door system
- One piece snap-in magnetic door gasket for easy replacement
- Heavy duty recessed door handles that stay out of the way

Preparation Area

- 1/2" thick foam insulated lids to prevent moisture build up and heat exchange
- Removable and adjustable sanitary 12 1/4" deep cutting board
- Sanitary PVC pans

Shelving

- Two epoxy coated wire shelves per section
- 304 stainless steel pilasters and shelf clips

Temperature Control

- Factory preset temperature, 35°F
- Setting temperature range from 33°F to 41°F
- Easy to set desired temperature with thermostat knob



Warranty

2 Years - Parts & Labor
5 Years - Compressor
(2 year parts & labor warranty is for products installed on or after July 1st 2010. Products installed before the date will have 1 year warranty.)

BACK MOUNT SANDWICH PREP TABLES

EPBN - Series

Back Mounted
Condensing Unit



DIMENSIONS

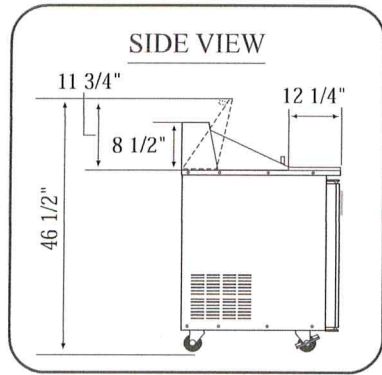

ALL UNITS

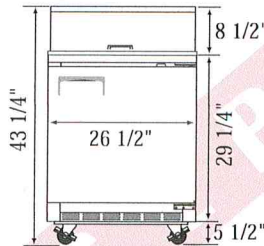
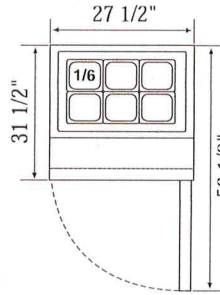

EPBNR1

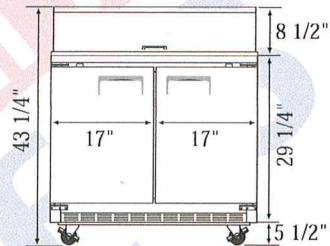
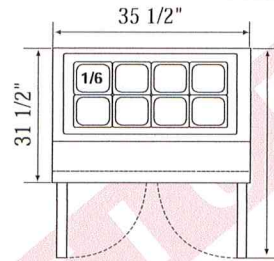

EPBNSR2

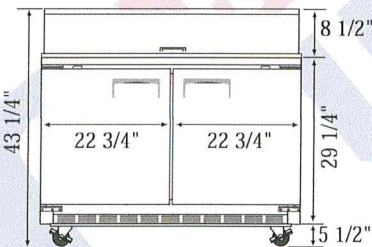
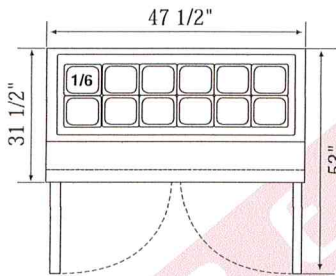

EPBNR2

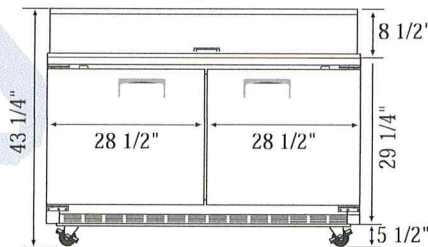
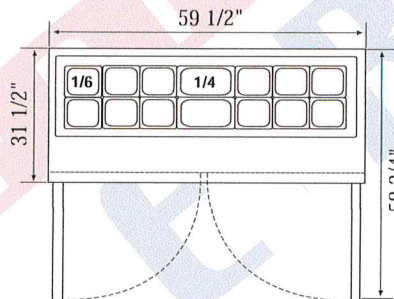

EPBNWR2

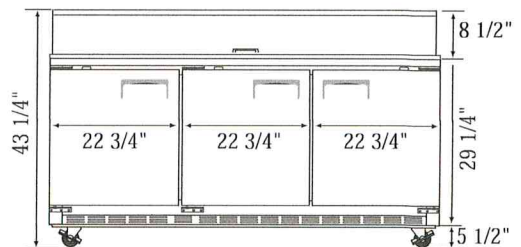
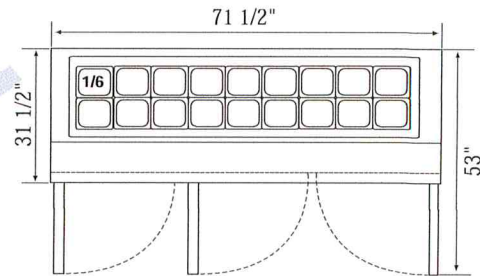

EPBNR3

Model	Ref/ Fzr/ Dual	# of Doors	Capacity (Cu.Ft.)	HP	Refrigerant	# of Shelves	# of Pans	Power (V-Hz-Ph)	Amps	Crated Weight (LBS)	Exterior Dimensions (Inches)		
											L	D	H*
EPBNR1	Ref	1	6.5	1/5	R-134A	2	1/6 x 6	115-60-1	4.00	227	27 1/2	31 1/2	37 3/4
EPBNSR2	Ref	2	8.5	1/5	R-134A	4	1/6 x 8	115-60-1	4.20	278	35 1/2	31 1/2	37 3/4
EPBNR2	Ref	2	11.8	1/4	R-134A	4	1/6 x 12	115-60-1	4.20	317	47 1/2	31 1/2	37 3/4
EPBNWR2	Ref	2	15	1/3	R-134A	4	1/6 x 12 1/4 x 2	115-60-1	5.01	357	59 1/2	31 1/2	37 3/4
EPBNR3	Ref	3	18.3	1/3	R-134A	6	1/6 x 18	115-60-1	5.20	428	71 1/2	31 1/2	37 3/4

* Height does not include 5" for caster.

Ref = Refrigerator Fzr = Freezer Dual = Ref & Fzr Combo H = Half Door